

# 金属磁粉心

## 铁镍钼粉心

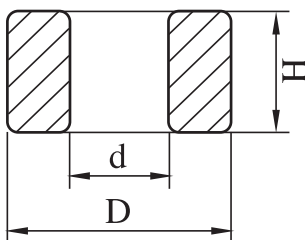

规格	A <sub>L</sub> ± 15% (nH/N <sup>2</sup> )	标准尺寸 (mm)			涂层后尺寸 (mm)			Le (cm)	Ae (cm <sup>2</sup> )	Ve (cm <sup>3</sup> )
		D	d	H	D(Max.)	d(Min.)	H(Max.)			
Y60-067	26									
Y125-067	55	6.70	3.00	3.00	7.42	2.54	3.76	1.52	0.055	0.084
Y160-067	70									
Y60-078	25									
Y125-078	52	7.87	3.96	3.18	8.51	3.43	3.81	1.79	0.062	0.110
Y160-078	66									
Y60-085	31									
Y125-085	66	8.50	3.50	3.30	9.14	2.96	3.95	1.88	0.080	0.155
Y160-085	84									
Y60-095	21									
Y125-095	44	9.53	5.21	3.25	10.2	4.71	3.90	2.31	0.064	0.147
Y160-095	56									
Y60-096	25									
Y125-096	53	9.65	4.78	3.18	10.3	4.27	3.81	2.18	0.075	0.164
Y160-096	68									
Y60-096A	32									
Y125-096A	66	9.65	4.78	3.96	10.3	4.27	4.60	2.18	0.095	0.206
Y160-096A	84									
Y60-102	32									
Y125-102	66	10.2	5.08	3.96	10.8	4.57	4.60	2.38	0.100	0.238
Y160-102	84									
Y60-112	26									
Y125-112	53	11.2	6.35	3.96	11.9	5.84	4.72	2.69	0.091	0.244
Y160-112	68									
Y60-127	27									
Y125-127	56	12.7	7.62	4.75	13.5	6.99	5.51	3.12	0.114	0.356
Y160-127	72									
Y60-130	35									
Y125-130	73	13.0	8.00	6.40	13.8	7.40	7.20	3.23	0.154	0.496
Y160-130	93									
Y60-165	35									
Y125-165	72	16.5	10.2	6.35	17.4	9.53	7.11	4.11	0.192	0.789
Y160-165	92									

# 铁镍钼粉心

规格	A <sub>L</sub> ± 12% (nH/N <sup>2</sup> )	标准尺寸 (mm)			涂层后尺寸 (mm)			Le (cm)	Ae (cm <sup>2</sup> )	Ve (cm <sup>3</sup> )
		D	d	H	D(Max.)	d(Min.)	H(Max.)			
Y60-173	43	17.3	9.65	6.35	18.1	9.02	7.15	4.14	0.232	0.960
Y125-173	89									
Y160-173	114									
Y60-202	32	20.3	12.7	6.35	21.1	12.1	7.15	5.09	0.226	1.15
Y125-202	68									
Y160-202	87									
Y60-229	43	22.9	14.0	7.62	23.7	13.4	8.42	5.67	0.331	1.88
Y125-229	90									
Y160-229	115									
Y60-229A	53	22.9	14.0	9.53	23.7	13.4	10.3	5.67	0.413	2.35
Y125-229A	112									
Y160-229A	143									
Y60-236	51	23.6	14.4	8.89	24.3	13.8	9.65	5.88	0.388	2.28
Y125-236	105									
Y160-236	135									
Y60-269	75	26.9	14.7	11.2	27.7	14.1	12.0	6.35	0.654	4.15
Y125-269	157									
Y160-269	201									
Y60-330	61	33.0	19.9	10.7	33.8	19.3	11.5	8.15	0.672	5.48
Y125-330	127									
Y160-330	163									
Y60-360	56	35.8	22.4	10.5	36.7	21.5	11.3	8.98	0.678	6.09
Y125-360	117									
Y160-360	150									
Y60-399	81	39.9	24.1	14.5	40.8	23.3	15.4	9.84	1.07	10.5
Y125-399	168									
Y160-399	215									
Y60-467	135	46.7	24.1	18.0	47.6	23.3	18.9	10.7	1.99	21.3
Y125-467	281									
Y160-467	360									
Y60-508	73	50.8	31.8	13.5	51.7	30.9	14.4	12.7	1.25	15.9
Y125-508	152									
Y160-508	195									
Y60-572	75	57.2	35.6	14.0	58.1	34.7	14.9	14.3	1.44	20.7
Y125-572	156									
Y160-572	200									
Y60-572A	140	57.2	35.6	28.0	58.1	34.7	28.9	14.3	2.89	41.3
Y125-572A	300									
Y160-572A	384									
Y60-778	68	77.8	49.2	12.7	79.0	48.0	13.9	20.0	1.77	34.7
Y125-778	142									
Y60-778A	136									
Y125-778A	284	77.8	49.2	25.4	79.0	48.0	26.7	20.0	3.55	69.5

# 铁镍钼粉心

# 金属磁粉心



磁化曲线 (B-H)

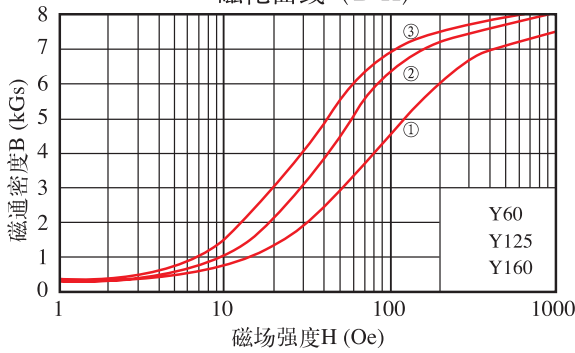

磁导率-频率曲线 ( $\mu$ -f)

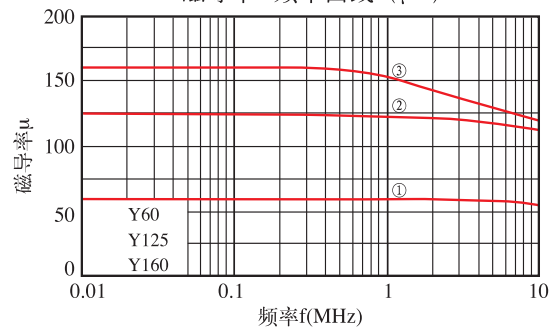

振幅磁导率-磁通密度峰值曲线 ( $\mu_a$ -Bpk)

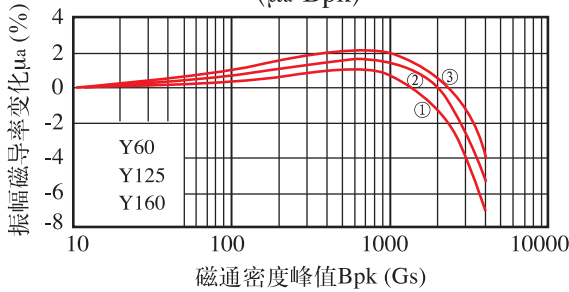

功率损耗曲线 ( $P_o$ -f&Bpk)

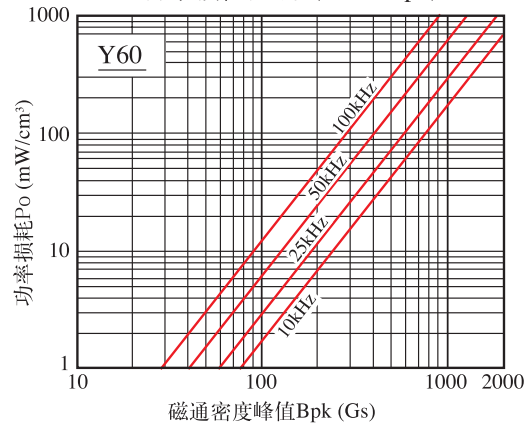

磁导率-温度曲线 ( $\mu$ -T)

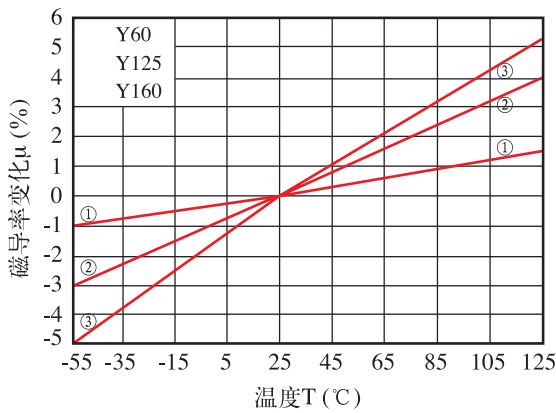

功率损耗曲线 ( $P_o$ -f&Bpk)

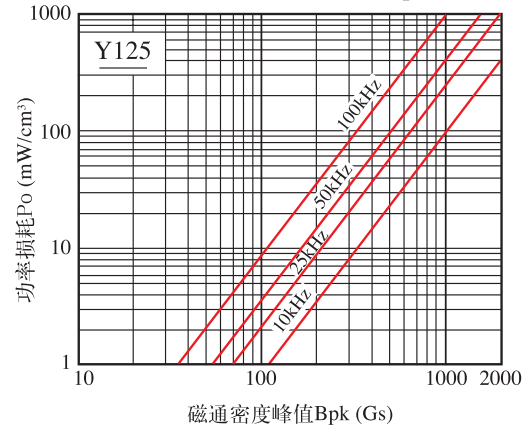

磁导率-直流偏磁曲线 ( $\mu$ -H<sub>o</sub>)

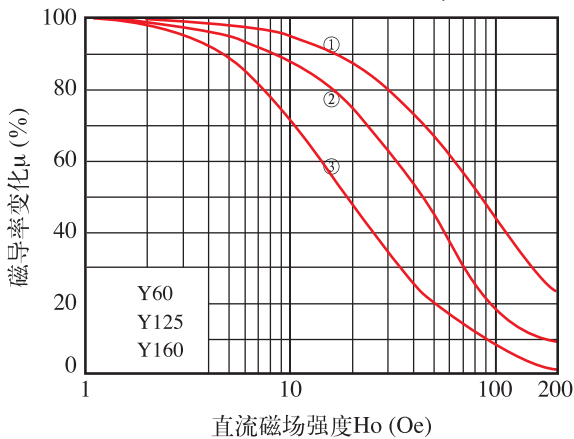

功率损耗曲线 ( $P_o$ -f&Bpk)

